

Dimensions subject to change without notification.

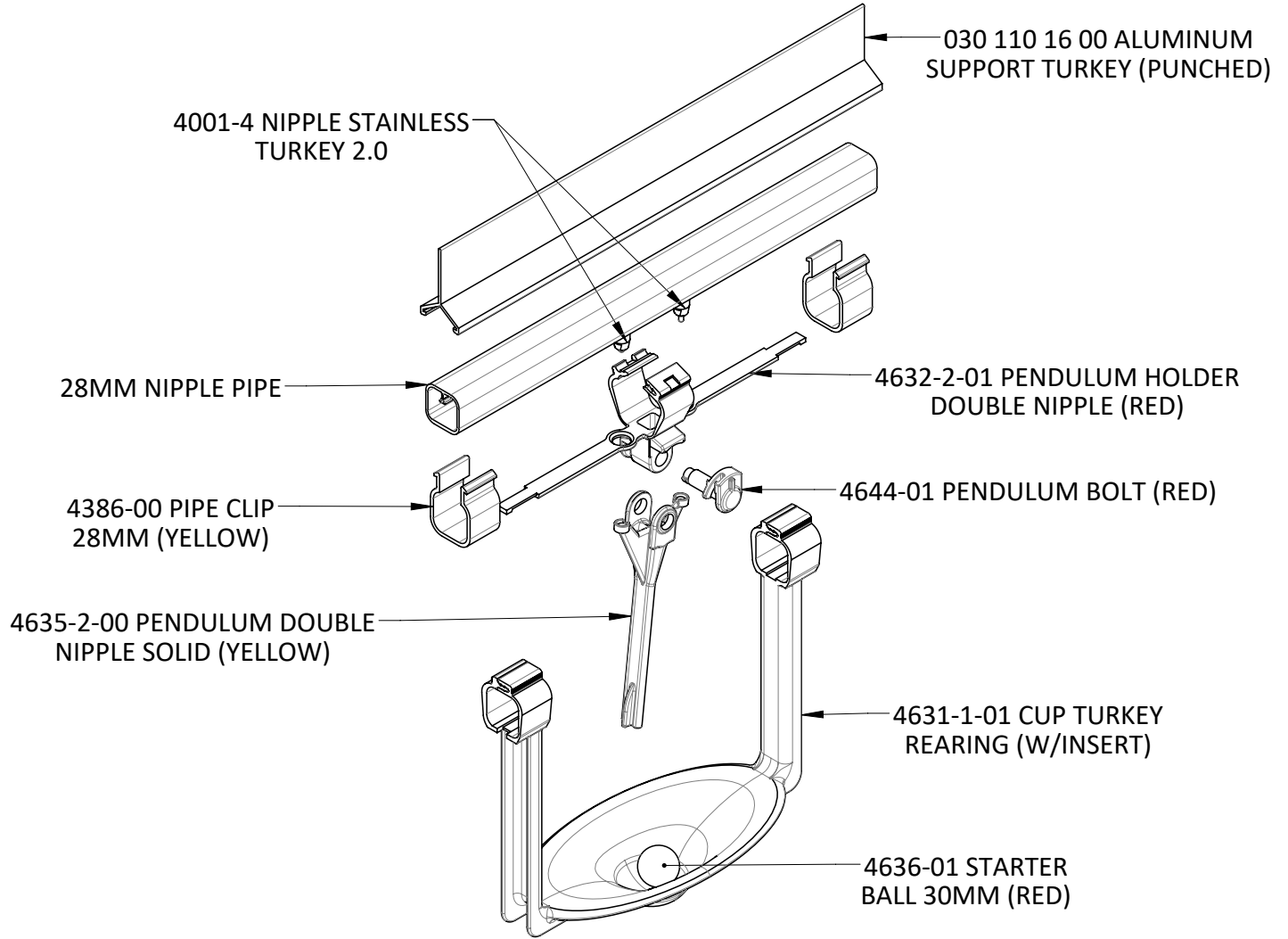

Dimensions subject to change without notification.

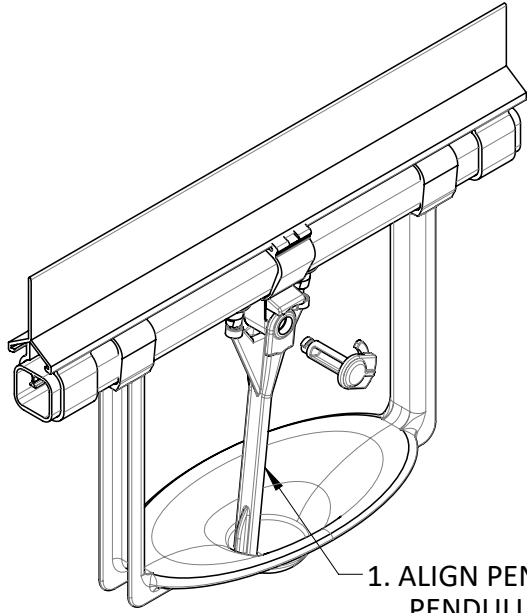

2. INSERT PENDULUM BOLT INTO PENDULUM

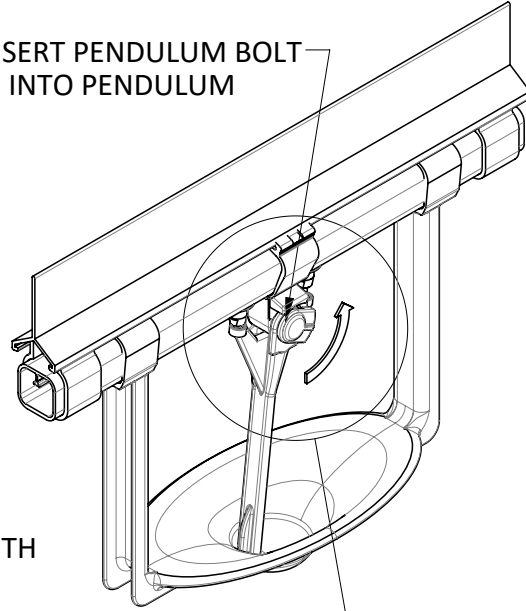

3. ROTATE COUNTER CLOCKWISE UNTIL LOCKING TAB SNAPS INTO POSITION

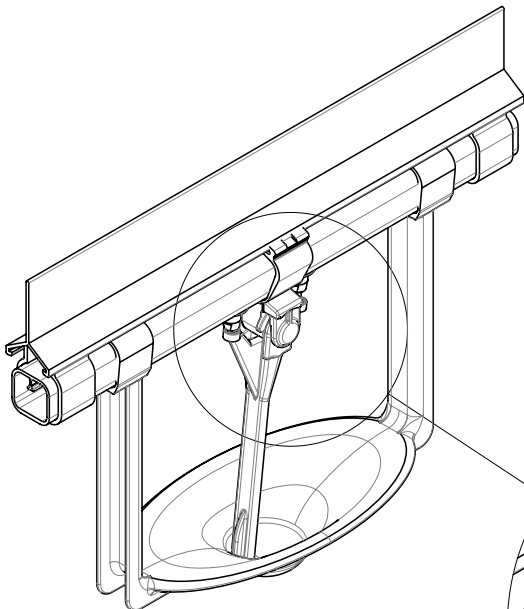
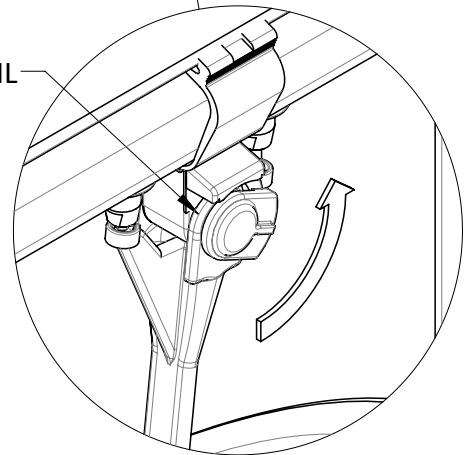

4. FINAL LOCKED POSITION

5. TO DISASSEMBLE PRESS TAB AND ROTATE CLOCKWISE TO REMOVE

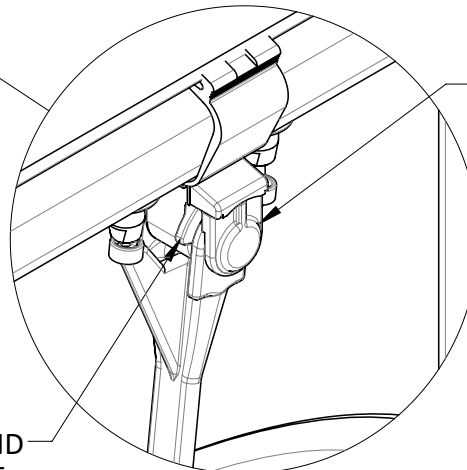

Dimensions subject to change without notification.

## EasyLine Management Recommendations

### DAY 1 - AT PLACEMENT

- Check to make sure the incoming house pressure is between 25-30 psi.
- Adjust standpipe pressure to 6" - 8".
- Place starter balls in cups prior to placing poults.
- Adjust the height of drinker line so that the bottoms of the cups are just above the litter.
- Take care to see the cups are low enough for poults to easily see and find the water.

### DAY 5 - 7

- Remove the starter balls from the cups.
- Raise water line height approximately 1".

### DAYS 7-10

- Raise the water line height where poults are just able to reach over the edge of the cup into the bottom to drink easily.

### FROM DAY 10 ONWARD

- Continue to raise water lines at least every two days keeping the line low enough that all birds can reach into the bottom of the cup but high enough that the edges of the cup are kept clean by the birds feathers "wiping" it off.

### AT WEEKS 5-6

- Level the drinker lines and make sure there are no high and low spots along the line. Increase standpipe pressure as necessary dependant upon age, density, and temperature.
- **NOTE: the tendency is to run more pressure than necessary, resulting in excessive water in the cups and spillage onto the litter.**

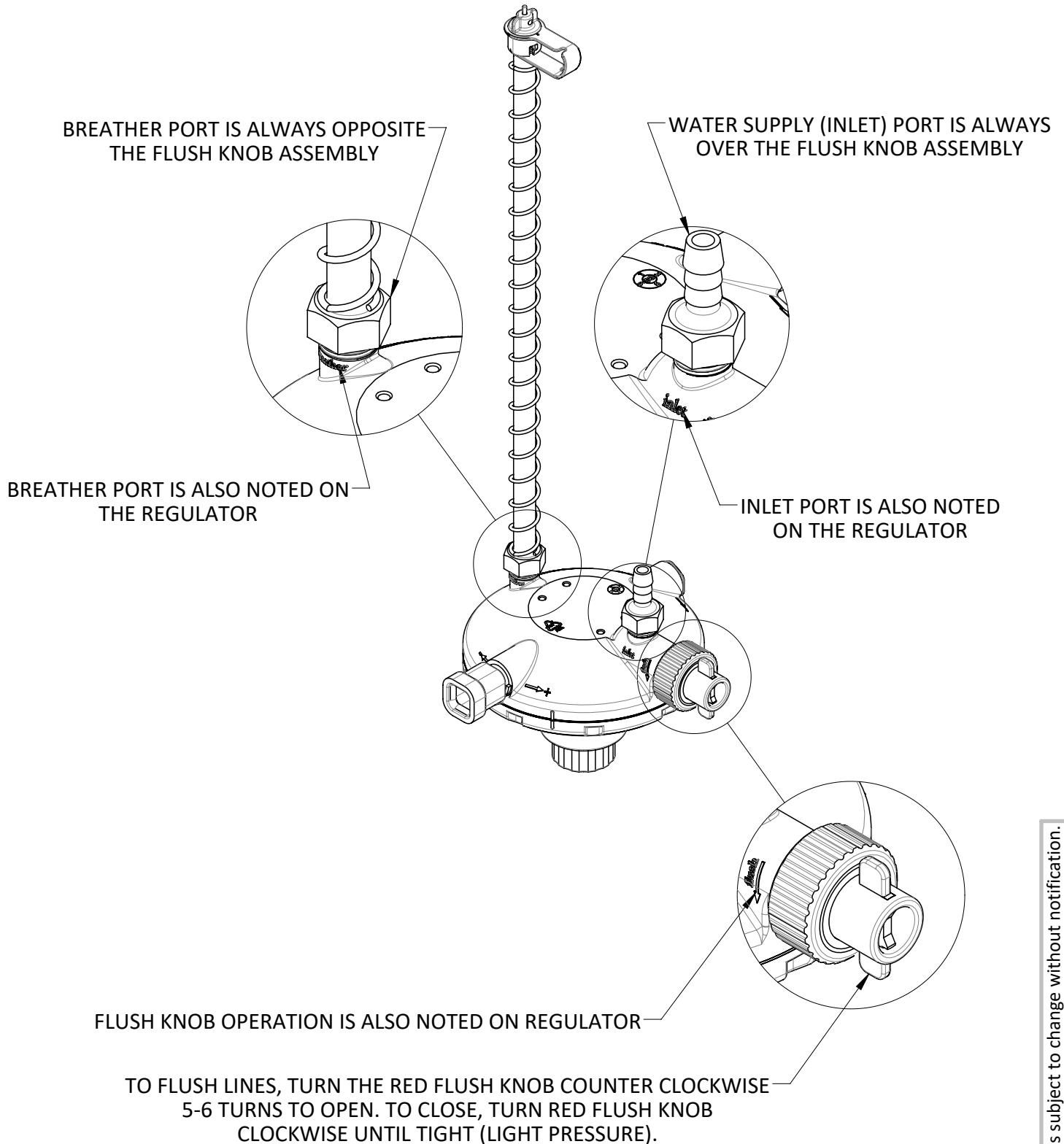

Dimensions subject to change without notification.

DRINKER SECTIONS SHOWN AS REFERENCE ONLY. CONNECTOR STYLE, HARDWARE, ETC. MAY VARY BY APPLICATION.

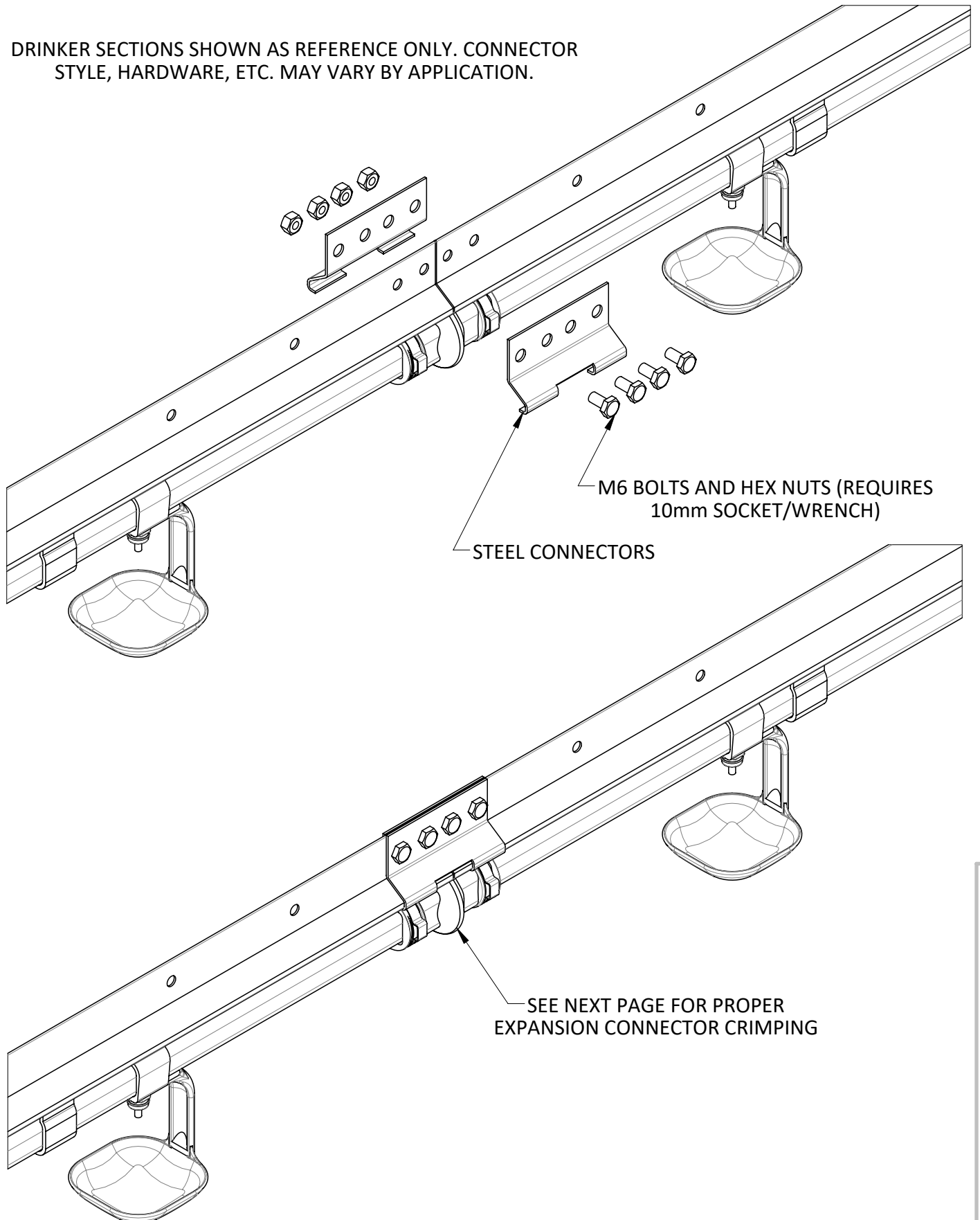

Dimensions subject to change without notification.

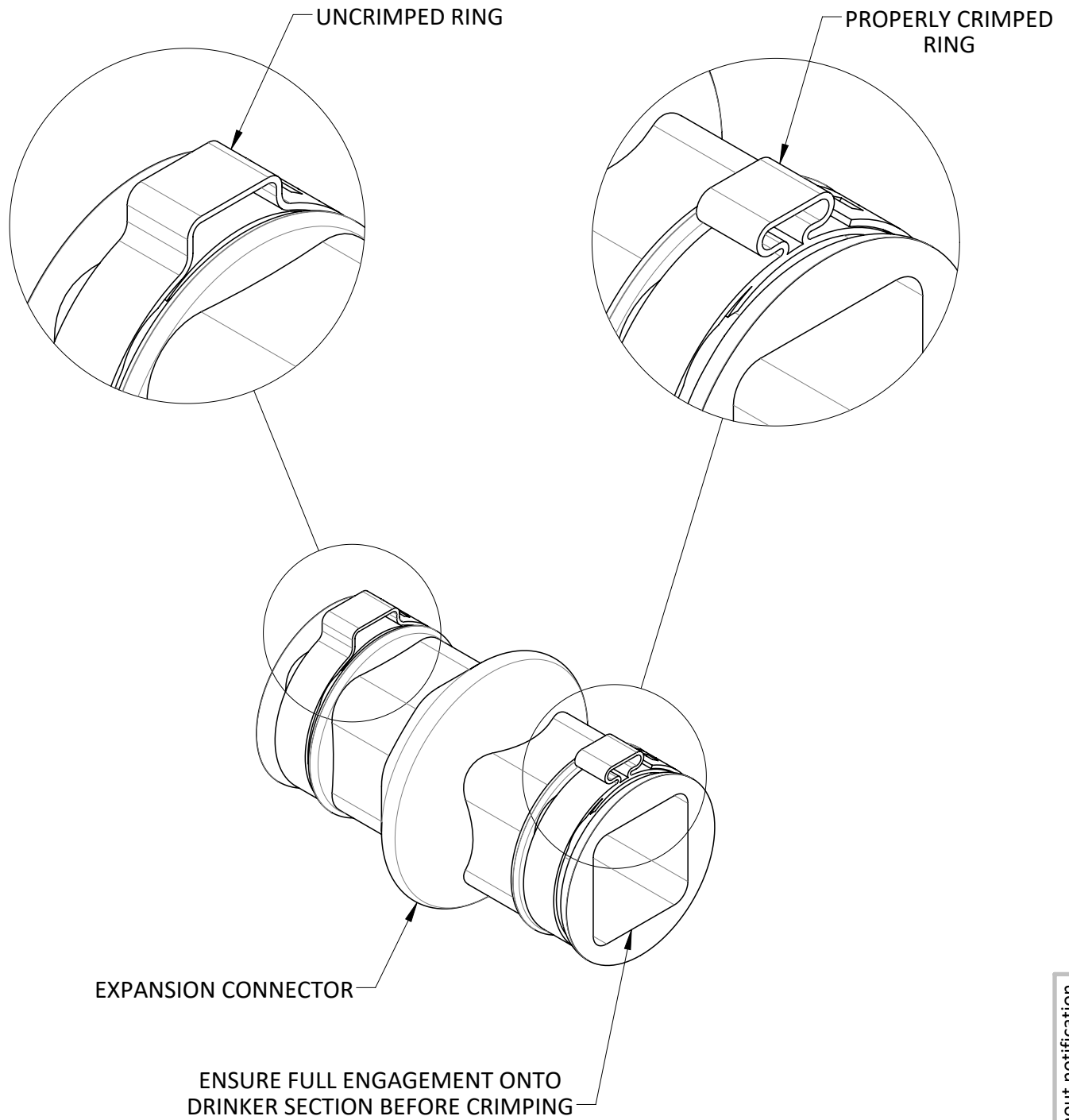

Dimensions subject to change without notification.